



# Banbury Active Travel Supporters

Notes from Zoom Meeting 11th March 2026



# Agenda

1. Western Corridor update including designs for the Tesco and Lockheed Close roundabouts.
2. Side-road pedestrian crossings. More info [here](#) and [here](#).
3. 10 worst roads for pedestrians to cross in Banbury.
4. Future Streets Project. More info [here](#).
5. Rail Station parking consultation. More info [here](#).
6. Banbury Traffic Advisory Committee and Parish Transport Representatives Committee feedback.

# Western Corridor route

## Western Corridor route

The “General Foods” factory is going to go but we do not know what will replace it or when this will happen. There could be some implications for cycle and pedestrian routes.

It would be a good idea to look at this area to see how some of the shops could improve cycle/pedestrian access . . especially Tesco and Aldi.

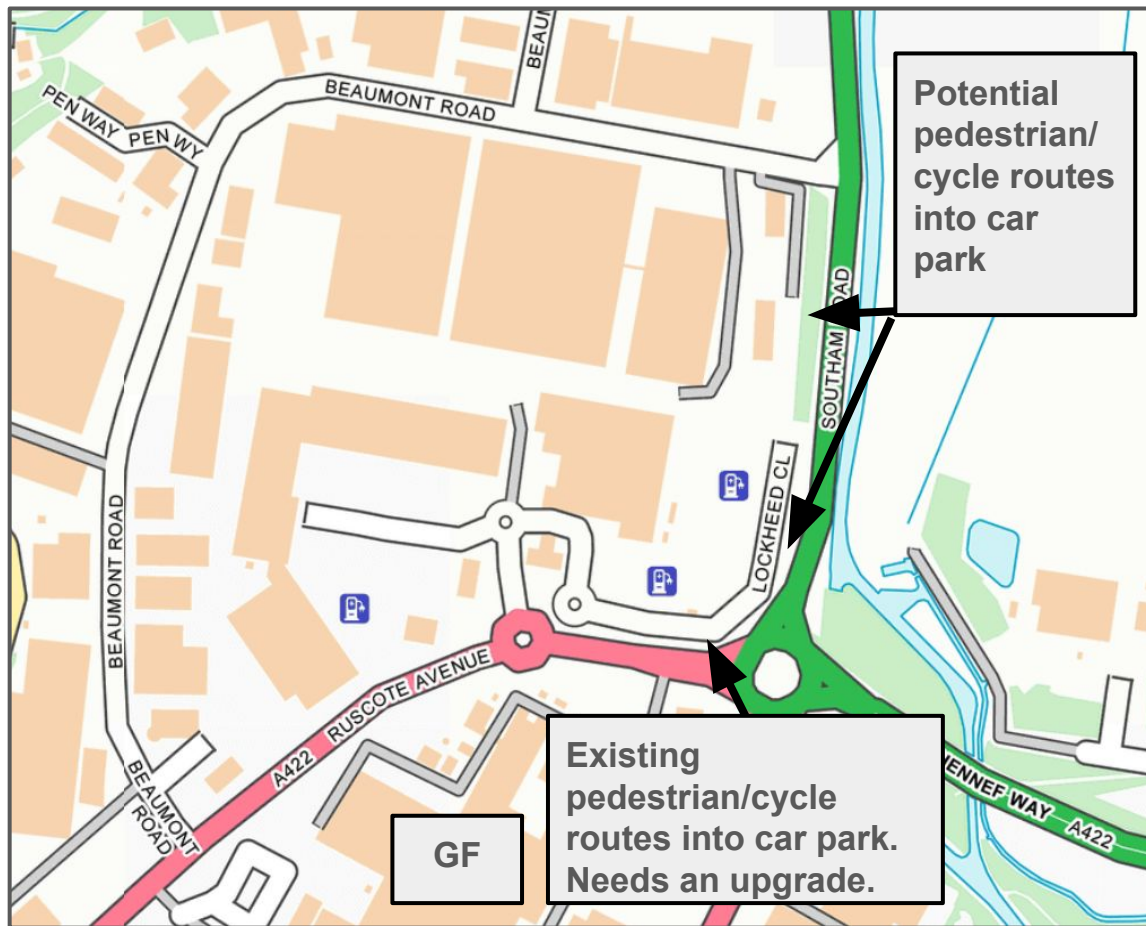

# Western Corridor route

3 options have been proposed for this section. This 2b option is the the favourite so far.

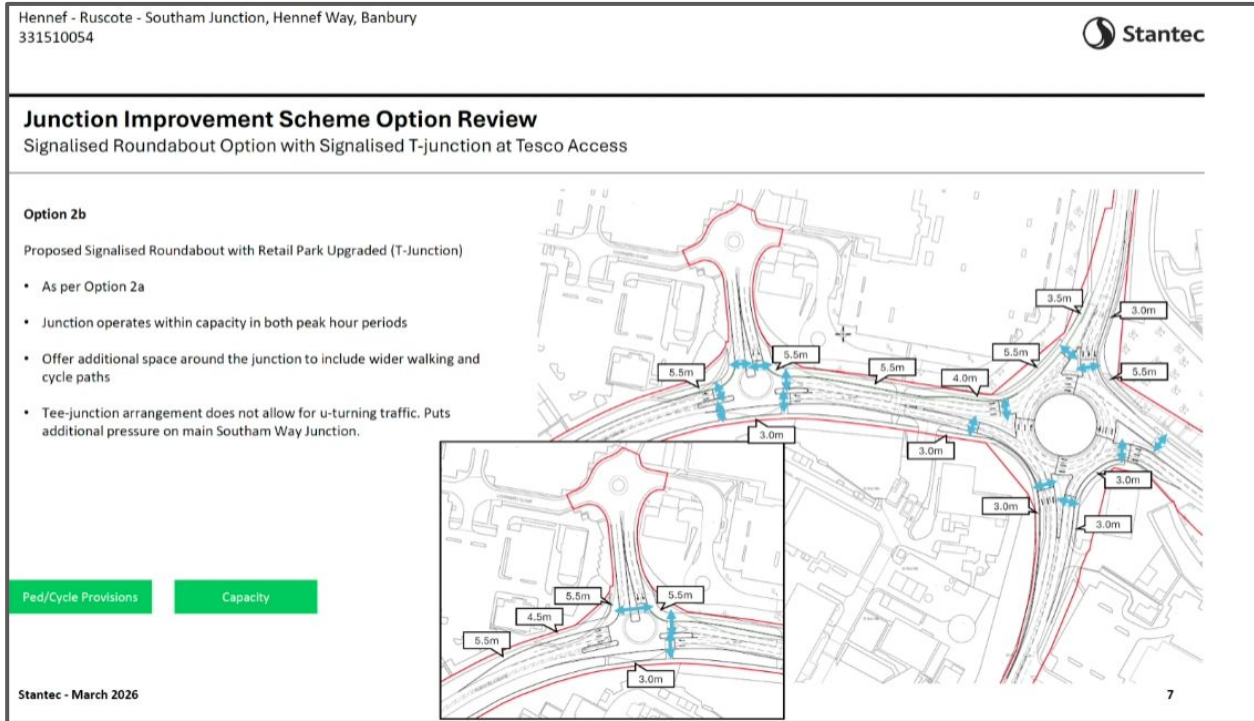

## Side-road Zebra crossings

The side-road Zebra crossing would make a perfect partner with the 20mph speed limit and it would be great to have a trial, near a school maybe, to see what people think of it. The advantages would be:

- **Improved safety:** By placing crossings at the mouth of side roads, drivers are forced to slow down before turning. This reduces the frequency of "left-turn" collisions where drivers may otherwise overlook pedestrians already crossing. This would be another step towards Vision Zero.
- **Enhanced priority:** These crossings reinforce the hierarchy of road users, clearly signalling that those walking or cycling have right-of-way over turning motor vehicles. This reduces pedestrian hesitation and wait times.
- **Accessibility and comfort:** If the crossing maintained the pavement level across the junction this would eliminate the need for dropped curbs, making travel significantly easier for wheelchair users, people with prams and those with limited mobility.
- **Encouraging active travel:** By creating a more seamless and direct walking environment, these crossings make local trips on foot more attractive and competitive compared to driving.
- **Traffic calming:** The physical design of these crossings acts as a visual cue for motorists to decrease speed, improving the overall safety environment of the neighbourhood.

## Side-road Zebra crossings: example

**Simpler zebra crossings may be popping up in your neighbourhood, helping pedestrians to cross new cycle routes and side roads.**

[More info?](#)  
[Click here.](#)

**Sheffield set to become UK's biggest city to trial new zebra crossings, hoping to boost active travel and cut road deaths**

**The new crossings are a hundred times cheaper than traditional zebras, but are not currently recommended by the Department for Transport.**

[More info?](#)  
[Click here.](#)



# Side-road Zebra crossings: Possible suitable sites for a trial of side-road Zebras in Banbury.

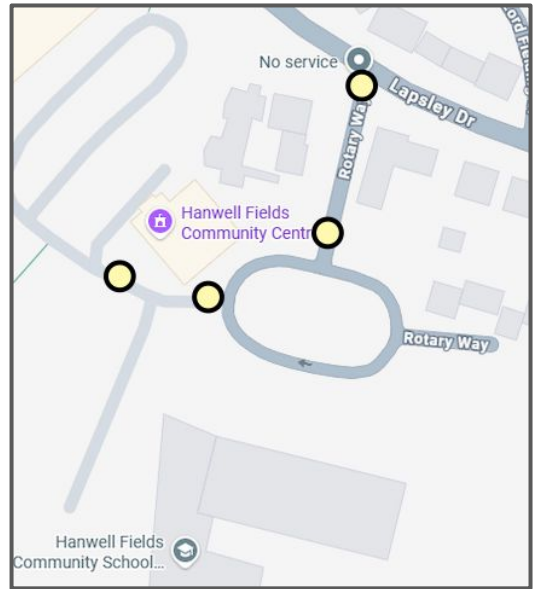
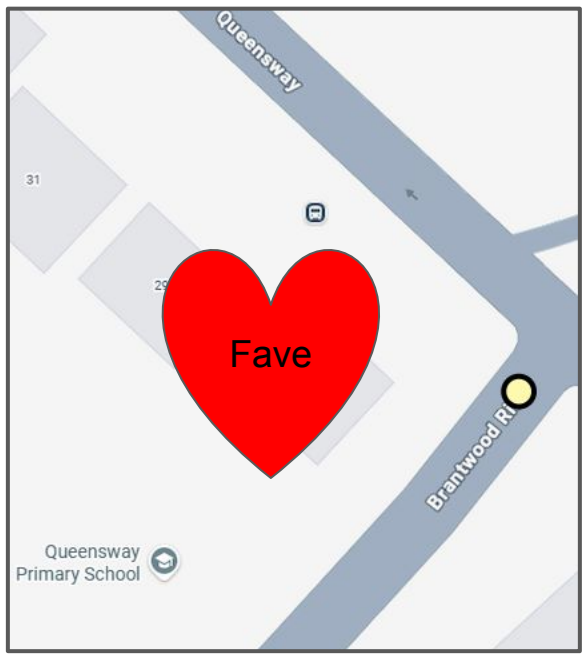
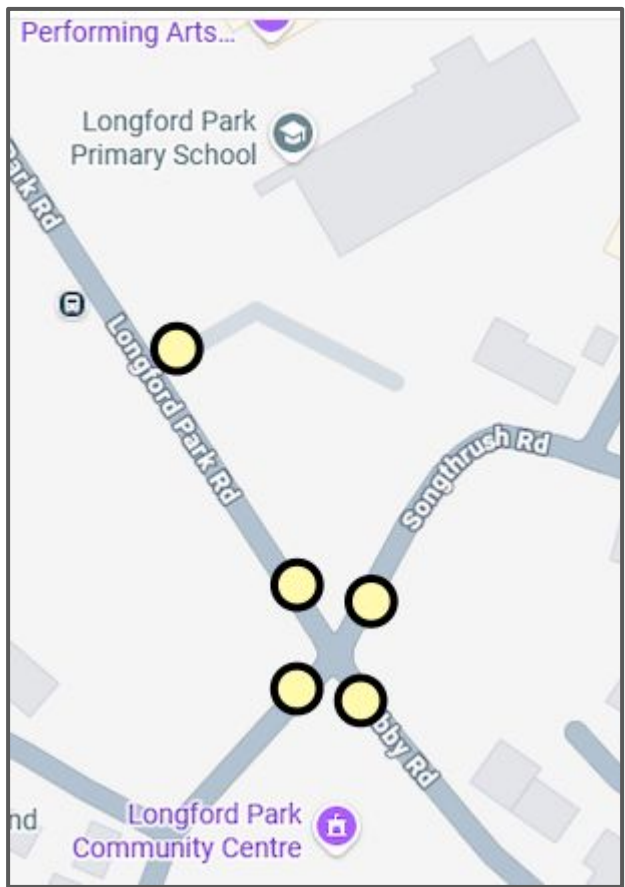

# **10 worst road crossings for pedestrians in Banbury!**

---

**Possible focus for a campaign to improve pedestrian routes in Banbury.**

**Contact newspaper and social media. Sample criteria below . .**

Worst crossings in Banbury: Sample criteria	Factor	Criteria
	Visibility	Can pedestrians see approaching traffic? Can drivers see pedestrians (including at night)?
	Traffic Speed	Is vehicle speed appropriate (low)? Or high traffic speeds making crossing dangerous?
	Traffic Volume	High volume, fast traffic, or frequent turning vehicles creating conflict?
	Surface/Kerbs	Are there dropped kerbs, tactile paving, and non-slip, even surfaces?
	Separation	Are pedestrians separated from vehicle flow (e.g., refuges/islands)?
	Visibility Obstructions	Are there parked cars, overgrown vegetation, or signs blocking sightlines?
	Desire Lines	Does the crossing align with where pedestrians want to walk?
	Wait Time	Is the wait time for a safe gap or green light excessively long?
	Crossing Width	Is there enough space on the footway/refuge for prams, wheelchairs, or crowds?
	Lighting	Is the crossing well-lit at night?
	Audio/Tactile	Are there working audible signals or rotating cones for the visually impaired?
	Staggered Crossing	Do staggered barriers cause significant delays or discomfort?

## Oxfordshire Liveable Streets: Future Streets Project

What if we could time travel to the future? And what if, when we got there, we found streets and neighbourhoods exactly as we needed them to be?

We're inviting people from across Oxfordshire to co-create a vision of thriving streets and neighbourhoods - and explore the practical pathways to bring this vision to life.

Through five workshops between March and September, we'll:

- Ground ourselves in where we are now
- Time-travel to imagine what thriving streets could look and feel like with futurist Rob Hopkins
- Co-design community-led indicators of change
- Map enabling conditions - what can we start doing now, to bring this future into the present moment.

Each workshop builds on the last, but can also be attended as a stand-alone event, so whether you join for one session or all five, you're part of a larger collective process.

# Oxfordshire Liveable Streets: Future Streets Project

## WORKSHOP 1

Understanding our streets today 24th March · 6:30-8:30 pm · Online

This workshop will introduce the workshop series and ground participants in 'place' and the system dynamics shaping Oxfordshire's streets and neighbourhoods.

## WORKSHOP 2

Future visions with Rob Hopkins 16th April · FULL DAY · In person, Oxford

Time-travel to 2040 with futurist Rob Hopkins. Picture what thriving streets and neighbourhoods could look and feel like - immersive, imagination-filled, and illustrated in real time with artist Richard Carman.

## WORKSHOP 3 & 4

Co-designing indicators of change 14th May and 9th June · 6:30-8:30 pm · Online

Co-design community-led indicators - the signals and stories of change we're working toward. What does progress look and feel like in everyday life?

## WORKSHOP 5

Bringing the future into the present (September - Date TBC) · In person, central Oxfordshire

We'll map enabling conditions that expand what's politically and practically possible beyond current policy and infrastructure constraints. We're seeking representation from local Government, businesses, residents, civil society groups and commons builders across Oxfordshire.

# Rail Station parking consultation (1).

We're asking for your views on the proposal to introduce an additional short-stay parking facility on Station Approach Road (South) in Banbury, which will comprise of six '30minute' parking spaces, as well as a '30minute Disabled Persons Parking Place'.

It will be located off the main carriageway southeast of the roundabout junction with Tramway Road/Station Approach Road (North).

Additionally, new 'No Waiting at Any Time' (double yellow lines) will also be introduced around the parking area, ensuring that parking is only available within the marked bays.

DEADLINE: Friday 03 April 2026

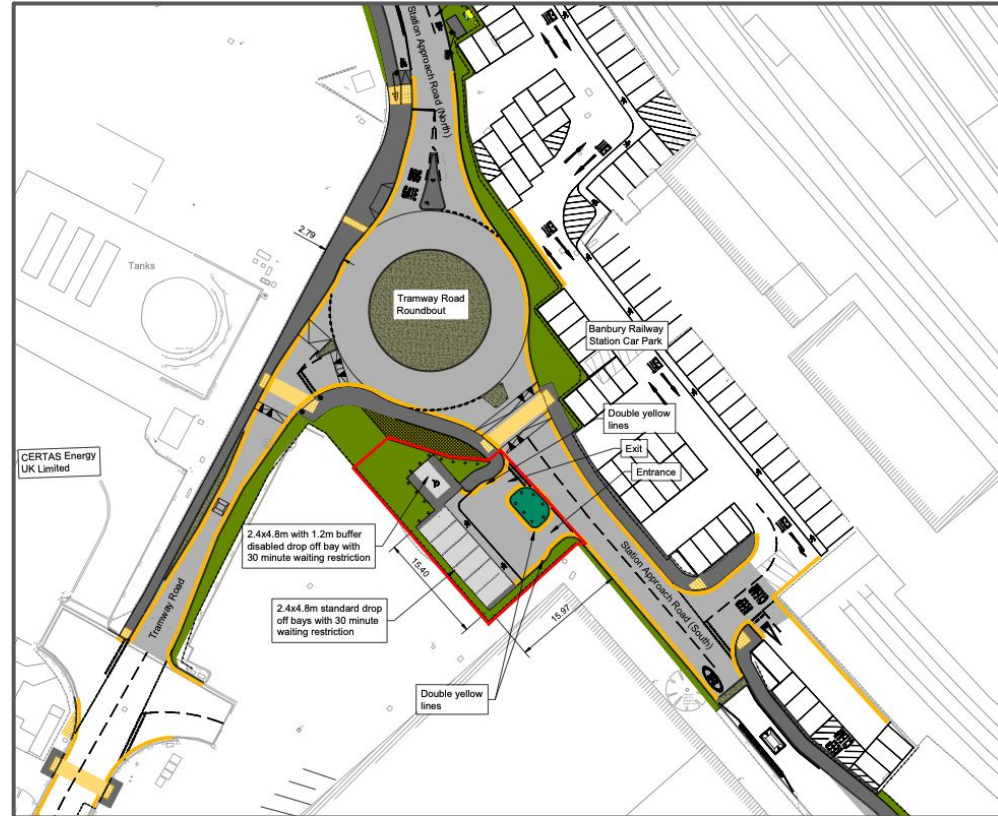

## Rail Station parking consultation (2).

We're asking for your views on the proposal to install 'Automatic Number Plate Recognition' (ANPR) cameras to help enforce the Bus Lane on the Station Approach Road (North). The Bus Lane is intended for use by local buses & pedal cycles only (with exemptions for emergency services, Taxi & private hire vehicles, and vehicles associated with Network Rails 'Rapid Response' unit).

The proposal is being put forward in order to help manage the safe & effective use of the bus gate, ensuring access is maintained for those exempted vehicles, and active enforcement of the signed restriction is able to take place.

**DEADLINE: Friday 24 April 2026**

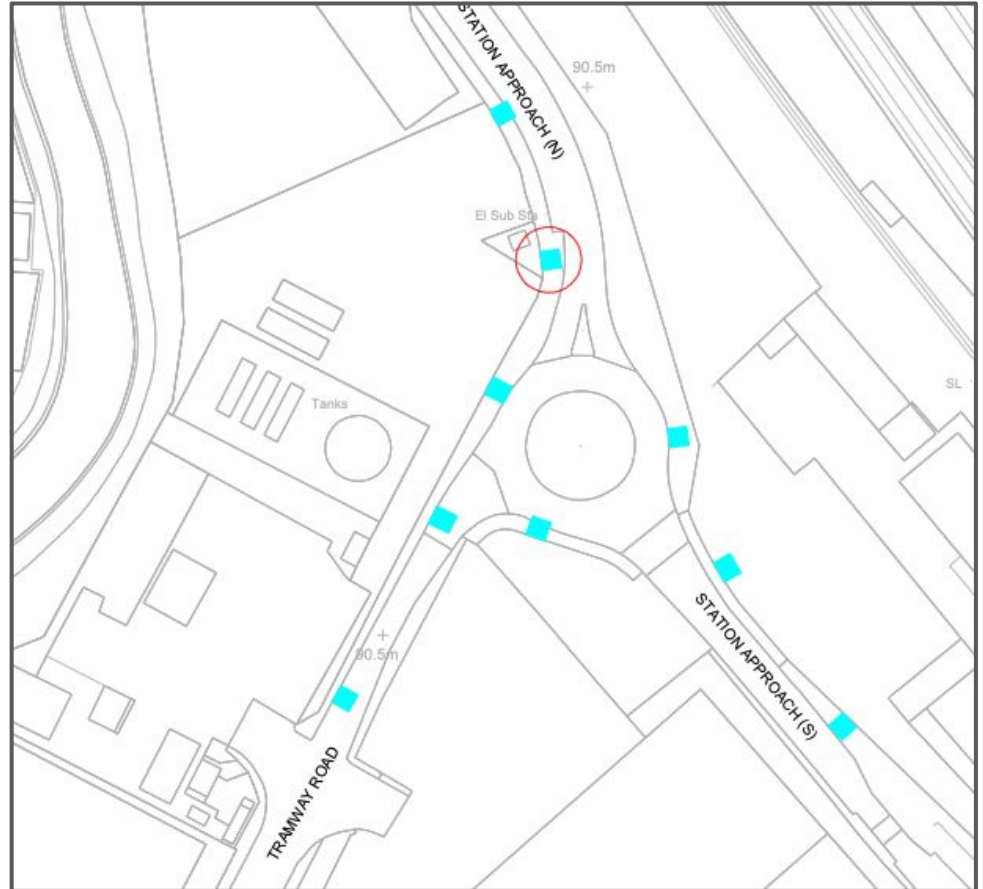

## Western Corridor route

**Oxford Friends of the Earth and Oxfordshire CPRE(Council for the Protection of Rural England) invite you to a workshop on ‘Effective Local Campaigning’.**

This is a 4 hour event – from 11am – 3pm – next Saturday, March 14th. It’s for anyone who wants to make their voice heard effectively on local planning or environmental issues. It will cover the basics of campaigning, building and keeping local support, running good events, working with media, and talking with politicians.

It’s taking place at Dean Court Community Centre, Pinnocks Way, Eynsham Rd. Oxford. You can book a ticket here:

<https://www.tickettailor.com/events/cpreoxfordshire/2069082>. As someone who has been involved with our work I can offer you a reduced fee of just £5. Use this discount code when booking - FoE-26.

## Useful links: Click

[Proposals for local government reorganisation in Oxfordshire](#)

[Oxon4Buses useful info](#)

[Regional Rail Strategy](#)

[The Ranty Highwayman](#)

[Active Travel Cafe](#)

[Oxfordshire Active Travel Roundtable](#)

[Chartered Institution of Highways and Transportation: Planning for walking](#)